

Cleerline SSF™ SC Connector

Termination With:
SSF™ Jacketed Fiber 2.0mm / 3.0mm

This guide assumes proper selection of connector matching cable type. Due to SSF™ fiber's extreme durability your cleaver may require a wheel height adjustment to successfully cleave SSF™ ²

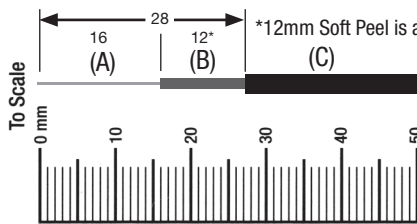

- (A) SSF™ Glass Fiber
(B) 250µm Soft Peel
(C) 2.0mm & 3.0mm Jacket

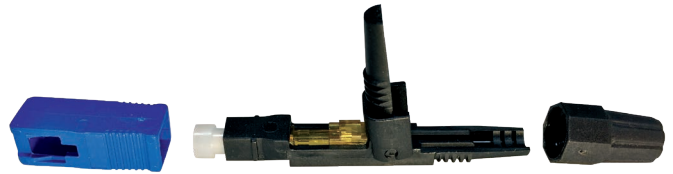

INSTRUCTIONS SHOW TERMINATION WITH CLEERLINE SSF™ FIBER.

THE STEPS ON THIS CARD DO NOT APPLY TO TRADITIONAL/NON-SSF™ FIBERS. Termination of traditional fiber requires different preparation steps. Refer to the instructional guide for traditional fiber at cleerlinefiber.com/resources.

Termination on 250µm SSF™ fiber (no jacketing or fan-out tube): Utilize included 250µm build-up tubes for proper connector installation. View instructions and video at cleerlinefiber.com/resources.

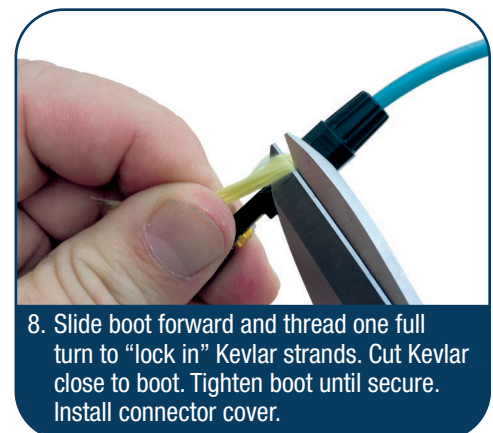
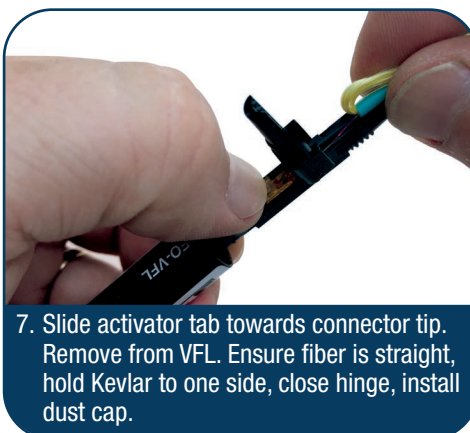
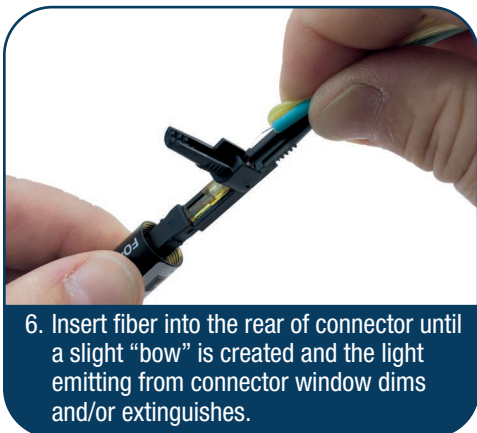
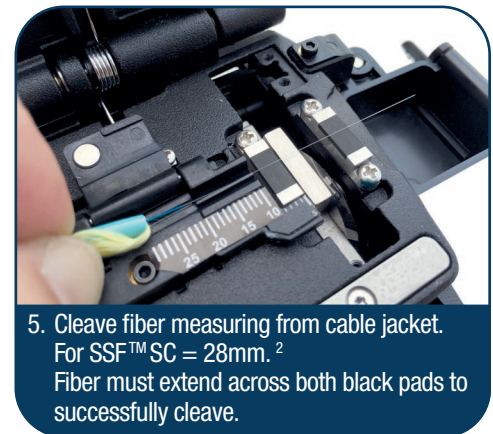
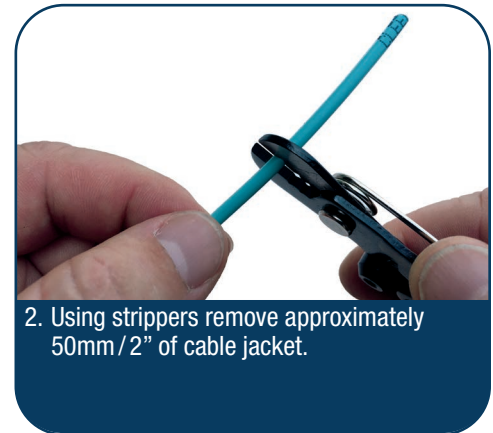
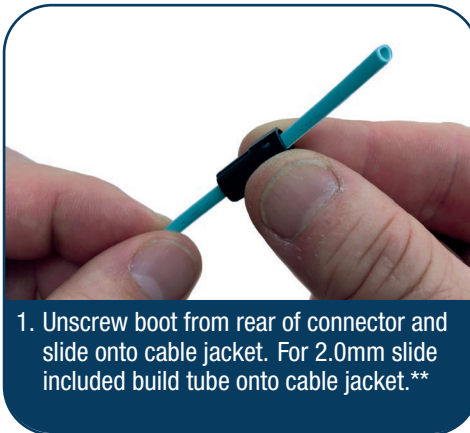

¹ SSF™ Fiber does not require the use of alcohol cleaning as the glass fiber is not exposed being protected with SSF™ Polymer coating. Remove the soft peel coating completely from all sides of the fiber with fingers only. Do not use strippers.

² Due to the extreme durability and bend insensitivity of SSF™ fiber your cleaver may require a wheel height adjustment procedure to allow successful cleaving of SSF™ fibers. For more information visit cleerlinefiber.com

Cleerline SSF™ SC Connector

Termination With:
SSF™ Fiber & 900µm fan out kit/tubing

This guide assumes proper selection of connector matching cable type and correct installation of 900µm fan out kit. Due to SSF™ fiber's extreme durability your cleaver may require a wheel height adjustment to successfully cleave SSF™²

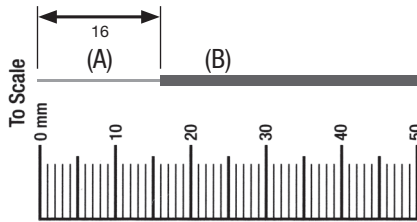

(A) SSF™ Glass Fiber
(B) 900µm Fan Tubing

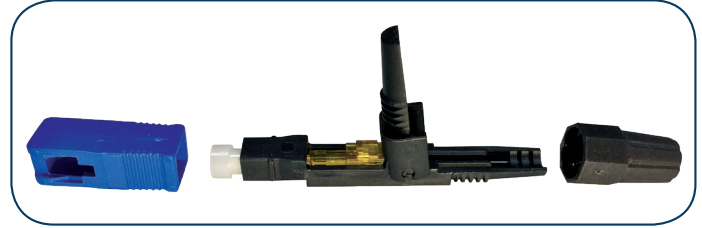

INSTRUCTIONS SHOW TERMINATION WITH CLEERLINE SSF™ FIBER.

THE STEPS ON THIS CARD DO NOT APPLY TO TRADITIONAL/NON-SSF™ FIBERS. Termination of traditional fiber requires different preparation steps. Refer to the instructional guide for traditional fiber at cleerlinefiber.com/resources.

Termination on 250µm SSF™ fiber (no jacketing or fan-out tube): Utilize included 250µm build-up tubes for proper connector installation. View instructions and video at cleerlinefiber.com/resources.

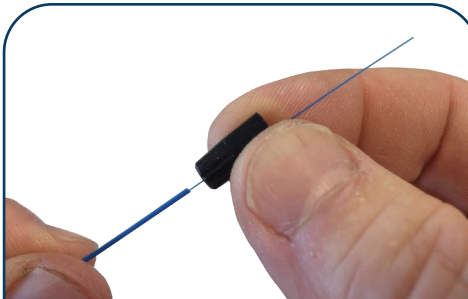

1. Ensure a minimum of 50mm of fiber exits the fan tubing. Unscrew boot from rear of connector and slide onto fan tubing.

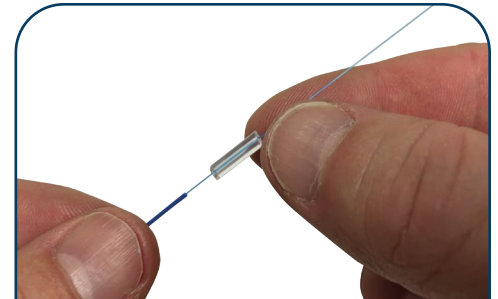

2. Slide included 900µm build tube section onto fan tubing.**



3. Place connector onto VFL. Ensure activator slide tab is in "open" position - slide towards rear of connector. Open hinge on connector.

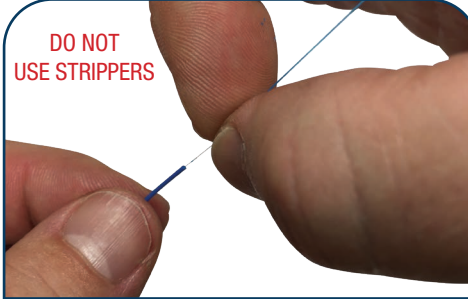

DO NOT USE STRIPPERS

4. Use only finger tips/nails to gently remove "Soft Peel" 250µm coating completely to fan tubing.¹

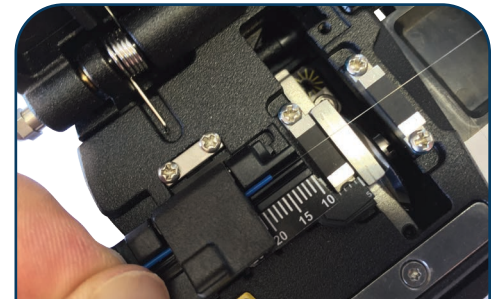

5. Cleave fiber measuring from fan tubing. For SSF™ SC = 16mm.² Fiber must extend across both black pads to successfully cleave.

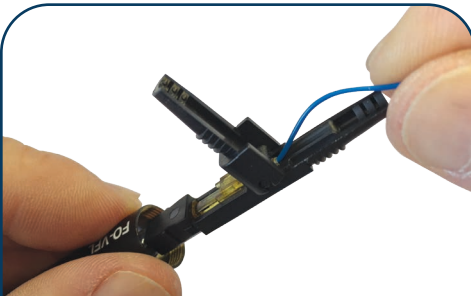

6. Insert fiber into the rear of connector until a slight "bow" is created and the light emitting from connector window dims and/or extinguishes.

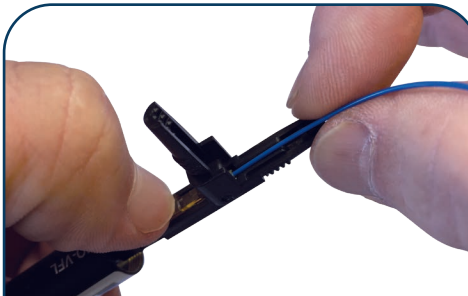

7. Slide activator tab towards connector tip. Remove from VFL, Install dust cap.

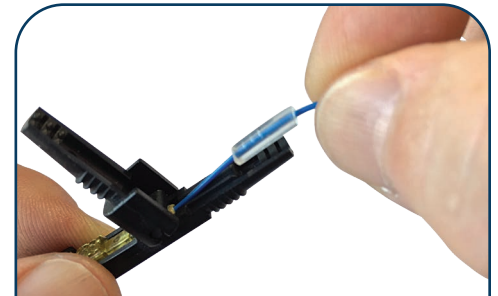

8. Slide build tube forward and seat in rear of connector, ensure fiber is straight, close hinge. Slide boot forward and tighten until secure. Install cover.

¹ SSF™ Fiber does not require the use of alcohol cleaning as the glass fiber is not exposed being protected with SSF™ Polymer coating. Remove the soft peel coating completely from all sides of the fiber with fingers only. Do not use strippers.

² Due to the extreme durability and bend insensitivity of SSF™ fiber your cleaver may require a wheel height adjustment procedure to allow successful cleaving of SSF™ fibers. For more information visit cleerlinefiber.com