

Installation instructions

- cerasonar fit series

cerasonar
invisible speakers

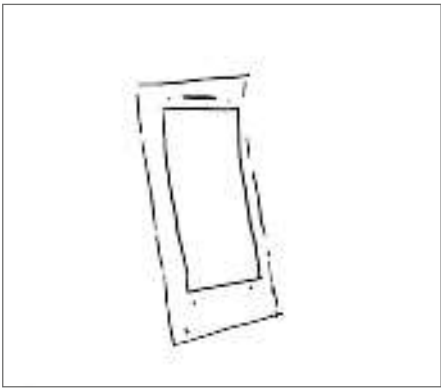

Check the construction for vibration noise, make sure the cavity has proper insulation. Attach the template on the wall or ceiling with tape

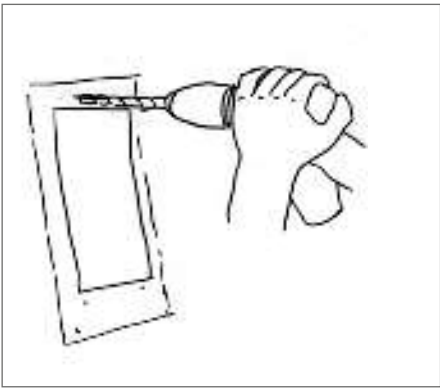

Drill four holes, these are intended for easy installation later. Drill size: 4 mm

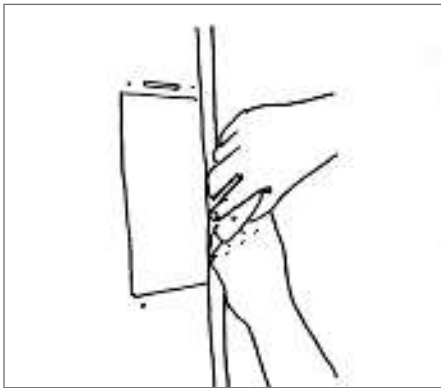

Mark the contours with a knife

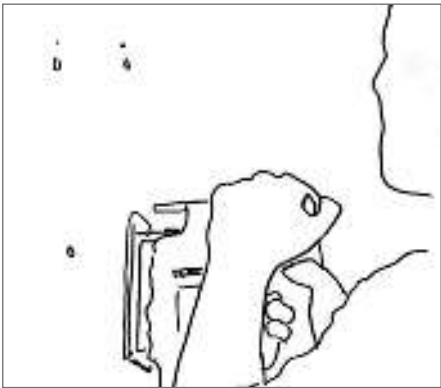

Cut out the marked contours with an appropriate tool

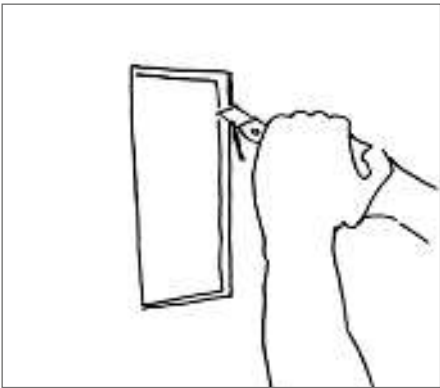

Smooth the edges and cut them by 45° furthermore moisten the edges for better joint with the filler

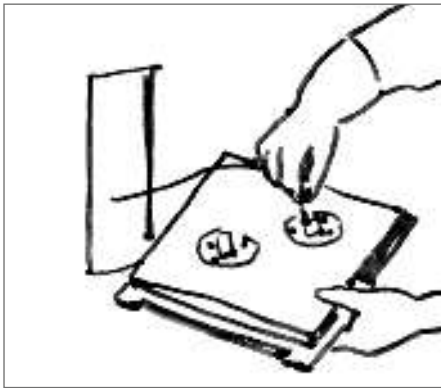

Strip the wire by 10 mm. Connect the speaker cable to the speaker, be aware of the polarity

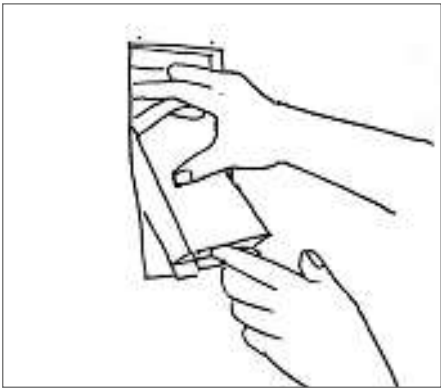

Insert the speaker, make sure there is no strain between the underlying insulation and speaker.

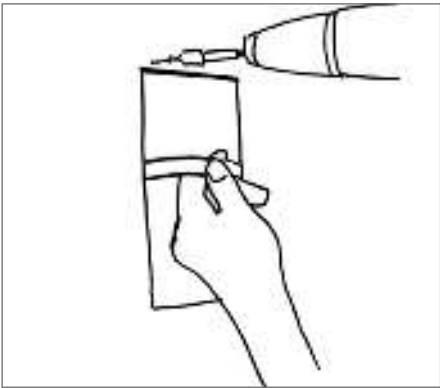

Use the delivered screws and tighten them carefully

ATTENTION: Test the speaker

Remove the installation strip

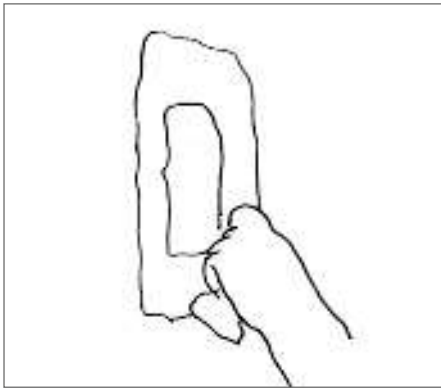

Use mesh tape in the plastering process. We recommend to use a flexible filler, e.g. Knauf Uniflott or Ardex 828

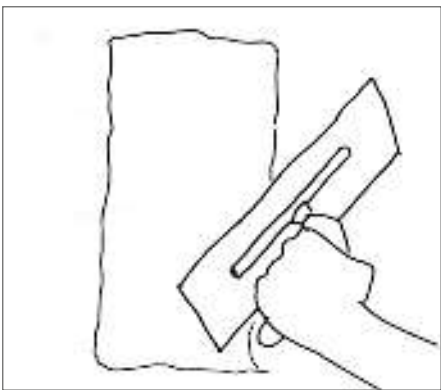

Up to 2mm of plaster can be applied Before using the speaker, let the plaster dry off. More information in the FAQ

cerasonar connection mono

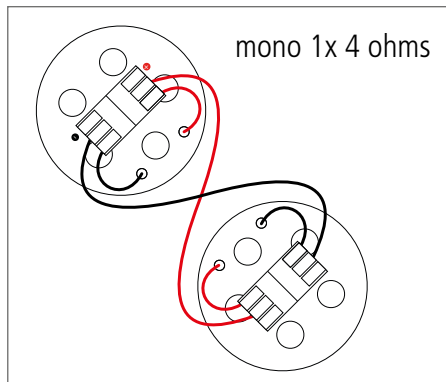

cerasonar connection single-stereo

