

# VI-1300



## Full HD Mini Dome IP Camera

- Full HD 1080p 30fps
- H.264 and MJPEG Compression
- True Day/Night and WDR
- Built-In IR Illuminator with 10m Viewing Distance
- Embedded Video Analytics
- MicroSD/SDHC Memory Card Slot
- Power-Over Ethernet (IEEE 802.3af)



| CAMERA               |  |
|----------------------|--|
| Model                | VI-1300  |
| Image Sensor         | SONY EXMOR 1/2.9" 1080p CMOS                     |
| Effective Pixels     | 1920 x 1080                                      |
| Scanning System      | Progressive scanning                             |
| AGC Control          | Auto   |
| Auto IRIS (DC)       | -  |
| Minimum Illumination | Color: 0.5 Lux/B/W: 0 Lux (IR LED On)            |
| Lens                 | 4.0mm, F1.8                                      |
| Angle of View        | Horizontal: Approx. 86°<br>Vertical: Approx. 51° |
| Shutter Time         | 1/10,000s to 1/2s                                |
| Day/Night & WDR      | True Day & Night (Removable IR_cut filter)       |
| Wide Dynamic Range   | Digital WDR                                      |
| Focus Assist         | Supported  |

| VIDEO                   |  |
|-------------------------|--|
| Video Compression       | H.264 Baseline, Main, High profile (MPEG-4 Part 10/AVC), MJPEG (Motion JPEG)   |
| Video Streaming         | Dual Stream, Configurable streams in H.264, MJPEG H.264: Controllable frame rate, bandwidth (VBR/CBR) MJPEG: Controllable frame rate, JPEG quality |
| Resolutions             | 1920 x 1080, 1280 x 720, 1120 x 630, 960 x 540, 800 x 450, 640 x 360, 480 x 270, 320 x 180   |
| Frame Rate              | H.264: Max 30fps in all resolution<br>MJPEG: Max 30fps in all resolution   |
| Image Settings          | Configurable brightness, contrast, saturation, sharpness   |
| Orientation Control     | Flip / Mirror / Corridor Mode(-90°, +90°)  |
| Noise Filter            | Supported (0 ~ 3)  |
| Smart Bitrate Control   | Supported (It works in VBR mode)   |
| Exposure Adjustment     | +1.0, +0.6, +0.3, 0, -0.3, -0.6, -1.0 EV   |
| White Balance           | ATW1/ATW2/Manual/Push  |
| Back Light Compensation | On (possible to designate zone)/Off  |
| Flicker Control         | Normal, 50Hz, 60Hz   |
| DSS (Sens-up)           | 2X ~ 16X   |
| Video Stabilization     | Supported  |
| Burnt-In Text           | Time stamp and text caption overlay  |
| Privacy Mask            | 4 configurable regions   |
| Analog Output           | -  |

| IR ILLUMINATOR      |   |
|---------------------|---|
| IR LED              | IR LED x 12 (850nm)   |
| IR Working Distance | 10m (30IRE)   |
| Smart IR            | Supported (Automatically adjust the infrared light to the best, according to the brightness of the scene) |

| EDGE STORAGE         |   |
|----------------------|---|
| Storage              | 1x MicroSD/MicroSDHC memory card slot (card not included)** |
| Recording Types      | Continuous Recording or Event Recording                     |
| Continuous Recording | Instant recording; Search & Download                        |
| Event Recording      | Search of Event Logs; Playback; Download                    |

| NETWORK           |   |
|-------------------|---|
| Ethernet Standard | 10/100 Base-T   |
| IP                | IPv4, IPv6  |
| Protocol          | QoS Layer 3 DiffServ, TCP/IP, UDP/IP, HTTP, HTTPS, FTP, RTSP, RTCP, RTP/UDP, RTP/TCP, mDNS, UPnP, SMTP, DHCP, DNS, DynDNS, NTP, SNMPv1/v2c/v3 (MIB-II), IGMP, ICMP, SSLv2/v3, TLSv1 |
| Security          | HTTPS (SSL), IP Filtering, Multi-level access with password protection  |
| Users             | Live viewing for up to 10 clients   |

| INTEGRATION                          |  |
|--------------------------------------|--|
| Application Programming Interface    | Software Development Kit (SDK) available   |
| ONVIF Compliance                     | Profile S, Profile G   |
| Event Sources                        | Video Motion Detection; Tamper Detection; Video Content Analytics (VCA); Network Loss/Detect; Network Setting Change; Time (Recurrence/Schedule) |
| Event Actions                        | File upload: E-mail, FTP<br>Notification: E-mail, FTP, HTTP, TCP<br>Recording<br>Event Log Saving  |
| Event Metadata Streaming (RTSP/RTMP) | Video Motion Detection (MD); Video Content Analytics (VCA)   |

| GENERAL                  |  |
|--------------------------|--|
| Material                 | Aluminum Die-Casting; Ivory                            |
| External I/O Terminals   | -  |
| Language on webpage      | Korean, English, Chinese, Dutch                        |
| Power Source/Consumption | DC 12V, PoE/Max. 5W @ DC 12V                           |
| Operating conditions     | Humidity up to 85% RH (non-condensing)<br>-20°C ~ 50°C |
| Approvals                | FCC, CE, KC  |
| Weight                   | 445g   |

| VIDEO ANALYTICS           |   |
|---------------------------|---|
| Analytics Engine          | Advanced tracking algorithm with rich library of detection behaviors      |
| Detection Zones and Rules | 40 zones (Multi-segment Polygons and Lines) in total<br>60 rules in total |
| Tamper Detection          | Supported   |
| Auto Tracking             | -   |
| VCA Preset                | -   |

| VIDEO ANALYTICS (Optional Features) |  |
|-------------------------------------|--|
| Complex Rules                       | Extends standard rules to allow various combinations of the inputs         |
| Detection Behavior                  | Enter, Exit, Appear, Disappear, Stop, Direction, Dwell filter; Tailgating; |
| Meta Data                           | Plain XML Format   |
| People Tracking                     | Tracks individuals separately among overlapped multiple people             |
| Color Filter                        | 10 colors in total; distinguish objects by color                           |

| AUDIO                 |  |
|-----------------------|--|
| Audio Streaming       | -  |
| Audio Compression     | -  |
| Audio input/output    | -  |
| 3D Behavior           | Perspective Corrected Size and Speed Filters           |
| Object Classification | Configured Max./Min. object sizes and Max./Min. speeds |
| Counting              | 20 counters in total                                   |
| Counting Line         | High accuracy people and vehicle counting              |

Preliminary Version Data subject to change without notice.

\*Please check firmware status. \*\*Class4 or higher SD cards are recommended for HD recording.

# VI-1300

## Dimensions

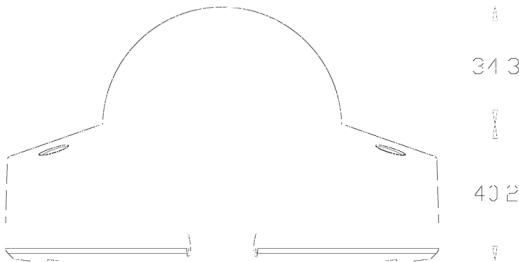
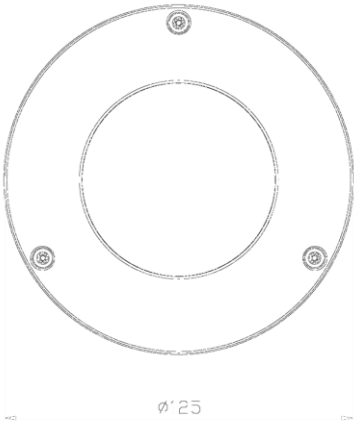

Preliminary Version Data subject to change without notice.

\*Please check firmware status. \*\*Class4 or higher SD cards are recommended for HD recording.